

# HUSKY

## Kitchen Fans

### About WOLF K

The low-watt WOLF K fan system is a powerful fully automatic kitchen fan. The fan is dual speed and utilises an energy efficient MagLev motor, offering great efficiency, quiet operation and exceptionally long life (up to 50,000 hours of operation).

This is a reliable fully automatic fan for effective humidity control. No user or installation set up is required. The fan can be operated at high speed extraction by switching to 'Manual'.



### Features and Benefits:

- Incorporates MagLev technology which means:
  - ◇ Almost silent operation
  - ◇ Cost effective as it is inexpensive to run, low maintenance and has a long life.
  - ◇ Can be fixed in any orientation without affecting performance (wall, ceiling, window)
- A removable stainless steel filter, which is dish washer safe, protects the fan blades and shutters giving longer life
- Electromechanical automatic shutters operate silently and prevent drafts
- The internal Autostat (humidity controller) is perfectly in tune with normal living conditions and;
  - ◇ Responds to changes (and uniquely, small changes) in air humidity therefore requiring no manual adjustment to retain the air quality in your home
  - ◇ Incorporates a data-logger that captures humidity, temperature and fan operation providing details on the dwelling air quality for improved condensation control management
- Polycarbonate ABS mix with fire retardant housing which provides a robust and high temperature resistant casing. Not only does this give you more choice in fan location but also a more effective ventilation system and removal of cooking moisture and odours
- The WOLF K has a built in LED indicator to show what mode the fan is in.
- Produces up to 225m<sup>3</sup>/h of air flow thereby conforming to building regulations part F



**WOLF K incorporates a 5 watt MagLev motor.**

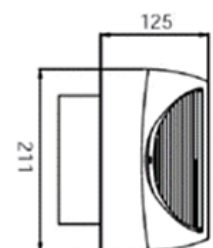
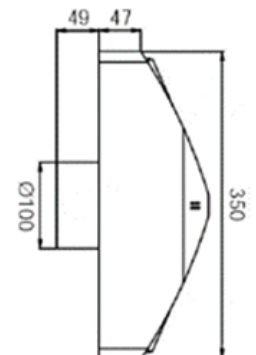

### What is MagLev Technology:

MagLev fans are derived from the most advanced train technology in the world. We have integrated the science behind making the MagLev trains float above the rails and propel forward, into our complete range of domestic fans.

The levitation of the blade and housing is created through opposing magnetic forces causing propulsion through perpendicular magnetic fields. This means that there is no physical contact between the moving parts and therefore no mechanical friction. This in turn means that the fan temperature is low and there is less waste of energy and less wear to the components. No friction also results in exceptionally high efficiency, quieter running and improved balance. All these features make a highly reliable motor with around 30 years life expectancy under normal operating conditions

Lifetime\* = lifetime of fan motor > 50,000 hours in normal operation

## HUSKY K and HUSKY 100K

Item	Part No.	Kit Contents
Fan + kit for wall installation	Husky k	Wall sleeve & external grille
Fan + kit for 112 mm wall installation	Husky 100K	Fan suitable to connecting to duct

## WOLF K and WOLF K Wiring

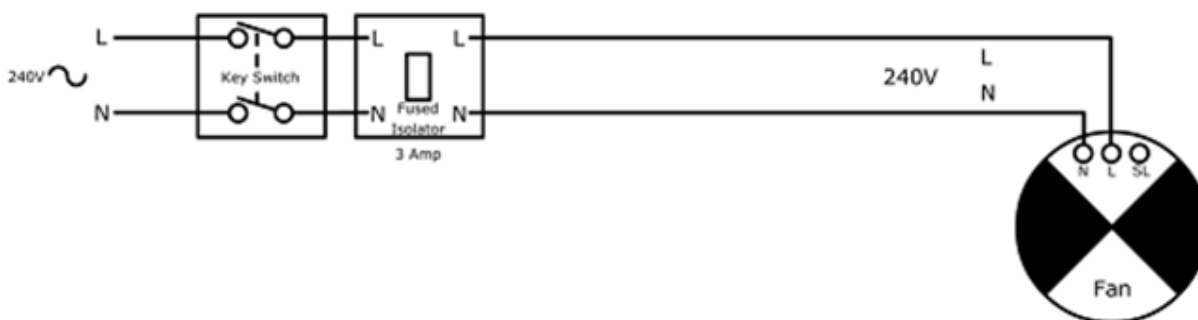

## General Notes on Fan Installations

The fan position should be as far as practical from the main source of air replacement. This is to avoid short-circuiting of the airflow. The Husky K has a 150mm spigot and sleeve (which is supplied) to an external grille (supplied as standard in brown, other colours are available upon request at time of order). The ducting hole through the wall requires a minimum of a 5 degree downward slope to the outside. For a wall installation a 160mm Ø hole is required.

The fan should be located at a high level close to the moisture source. If the room/dwelling contains a fuel burning device such as a gas boiler with a non-balanced flue, it is essential that there is enough replacement air to prevent fumes being drawn down the flue where the fan is extracting

The Husky 100 is suitable for mounting on to an existing duct system

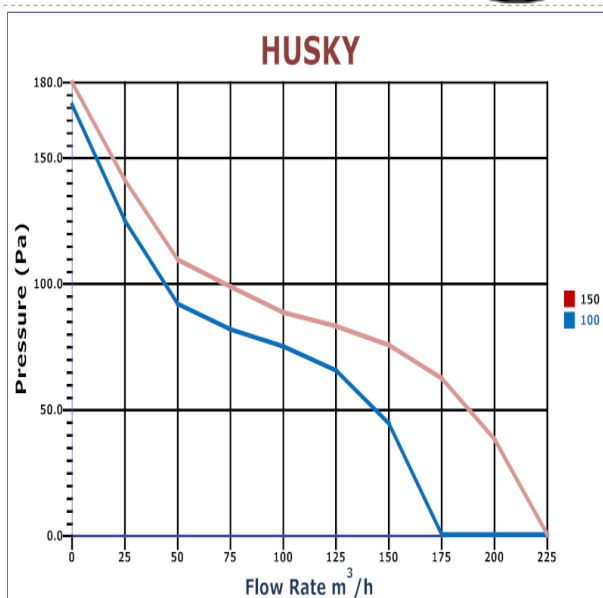

## And for the Specifier.....

The Husky is supplied with a 2 speed extractor fan with override switch, and can be installed through the kitchen wall or window. The fan will include a MagLev motor of not more than 2 x 5 watts extracting at no less than 225m³/h. The fan has automatic shutters, an Autostat humidity control and removable stainless steel filter

Product	POWER				
	Max Air Flow m³/h	Fan Input (watts)	Static Pressure (Pa)	Noise (dB(A))	Exhaust Spigot Size (mm)
HUSKY K	115-225	2 x 5	50	30	150
HUSKY 100K	115-225	2 x 5	100	34	100